

DT122

FLANGE TYPE DIAPHRAGM SEAL

RANGE

0 ~ 1 ...
40 bar

SIZE

1/2 ...
3 Inch

MEDIA

**Liquid
&
Gas**

SPECIFICATION

MODEL	DT122
SIZE	1/2", 3/4", 1", 1-1/2", 2", 3"
FLANGE RATING	JIS 10K JIS 20K ANSI 150# ANSI 300# PN16 PN25
BODY MATERIAL	Upper housing : 316SS Lower housing : 316SS
MEMBRANE MATERIAL	316LSS Hastelloy C276* Tantalum*
TEMPERATURE LIMITED	-40 ~ 150 °C Max. 350 °C* [with cooling element]

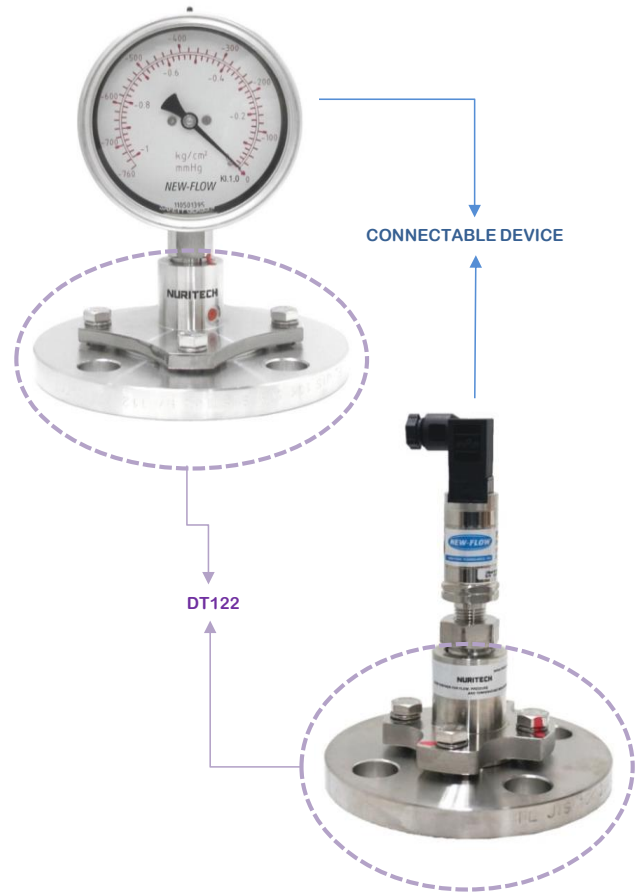

*=Optional

SIZE & PRESSURE RANGE

Membrane Size	36Φ	45Φ	75Φ
Minimum [bar]	0 ~ 10	0 ~ 6, -1 ~ 5	-1 ~ 0
Maximum [bar]	0 ~ 40	0 ~ 40	0 ~ 40
Minimum Flange Size	1/2"	3/4"	2"

DIMENSION (mm)

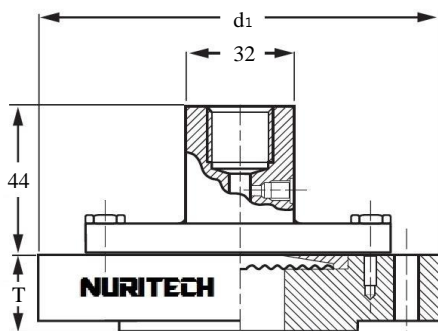

Item	Description of parts
a	Upper housing
b	Lower housing
c	Membrane
d	Instrument connection
e	Filling port
f	Screw bolt

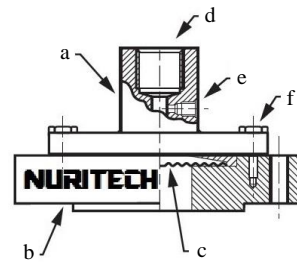

* The dimensions are according to the standard specifications of JIS, ANSI and DIN

* Note: d₁ & T dimension are according to the flange rating and size

제품의 사양에 따라 변경 될 수 있습니다.

| FLOW | | PRESSURE | | TEMPERATURE | | AC | | DC | | BATTERY | | OUTPUT | | CONTACT | | DISPLAY |

CONNECTABLE DEVICES

						
Model	PG	PGS	DPG3500	DPG3000	PT3100	PT5000
Accuracy	±1.6% F.S.	±1.0% F.S.	±1.0% F.S.	±0.5% F.S.	±0.5% F.S.	±0.2% F.S.
Gauge outdia.	60mm	100mm	80mm	75mm		
Output					DC4-20mA	DC4-20mA
Range Unit : bar or kg/cm2	-1 ~ 0 -1 ~ 1.5 -1 ~ 3 -1 ~ 5 -1 ~ 9 -1 ~ 15 -1 ~ 24 0 ~ 1 0 ~ 1.6 0 ~ 2.5 0 ~ 4 0 ~ 6 0 ~ 10 0 ~ 16 0 ~ 25 0 ~ 40	-1 ~ 0 -1 ~ 1.5 -1 ~ 3 -1 ~ 5 -1 ~ 9 -1 ~ 15 -1 ~ 24 0 ~ 1 0 ~ 1.6 0 ~ 2.5 0 ~ 4 0 ~ 7 0 ~ 10 0 ~ 16 0 ~ 20 0 ~ 25 0 ~ 28 0 ~ 35 0 ~ 40	0 ~ 3.5 0 ~ 7 0 ~ 14 0 ~ 20 0 ~ 35	-1 ~ 0 0 ~ 7 0 ~ 35	-1 ~ 0 -1 ~ 2.5 -1 ~ 4 -1 ~ 6 -1 ~ 10 -1 ~ 16 -1 ~ 25 0 ~ 1 0 ~ 2.5 0 ~ 4 0 ~ 6 0 ~ 10 0 ~ 16 0 ~ 25 0 ~ 40	-1 ~ 0 -1 ~ 2.5 -1 ~ 4 -1 ~ 6 -1 ~ 10 -1 ~ 16 -1 ~ 25 0 ~ 1 0 ~ 2.5 0 ~ 4 0 ~ 6 0 ~ 10 0 ~ 16 0 ~ 25 0 ~ 40

| FLOW | | PRESSURE | | TEMPERATURE | | AC | | DC | | BATTERY | | OUTPUT | | CONTACT | | DISPLAY |



Ordering Information

DT122	Model									
	Code	Instrument Connection	Code	Instrument Connection	Code	Instrument Connection				
	A	1/4" BSP Female	C	3/8" BSP Female	E	1/2" BSP Female				
	B	1/4" NPT Female	D	3/8" NPT Female	F	1/2" NPT Female				
		Code	Membrane size							
		A	ø36							
		B	ø45							
		C	ø75							
		Code	Process Connection	Code	Process Connection	Code	Process Connection			
		1	1/2"	4	1-1/2"	7	Option			
		2	3/4"	5	2"					
		3	1"	6	3"					
		Code	Flange rating	Code	Flange rating	Code	Flange rating			
		1	150#	4	PN25	7	Option			
		2	300#	5	JIS 10K					
		3	PN16	6	JIS 20K					
		Code	Upper housing material							
		S	SS316 [std.]							
		O	Option							
		Code	Lower housing material							
		S	SS316							
		O	Option							
		Code	Membrane material							
		1	SS316L							
		2	Hastelloy C276							
		3	Tantalum							
		4	Option							
		Code	Connectable Devices							
		P	PG (fill range)							
		PS	PGS (fill range)							
		D35	DPG3500 (fill range)							
		D30	DPG3000 (fill range)							
		P3	PT3100 (fill range)							
		P5	PT5000 (fill range)							
		Code	Test Certi.							
		Y	Issue.							
		N	None.							

| FLOW | | PRESSURE | | TEMPERATURE | | AC | | DC | | BATTERY | | OUTPUT | | CONTACT | | DISPLAY |