

DT110

THREAD TYPE DIAPHRAGM SEAL

RANGE

0 ~ 4 ...
40 bar

SIZE

1/4 ...
1/2 Inch

MEDIA

**Liquid
&
Gas**

SPECIFICATION

MODEL	DT110
CONNECTION	1/4", 3/8", 1/2" NPT, PF Male, Female
UPPER HOUSING MATERIAL	316SS
LOWER HOUSING MATERIAL	316SS 316LSS* Hastelloy C276* Tantalum* Titanium*
MEMBRANE MATERIAL	316LSS Hastelloy C276* Tantalum*
TEMPERATURE LIMITED	-40 ~ 150 °C Max. 350 °C* [with cooling element] *=-Optional

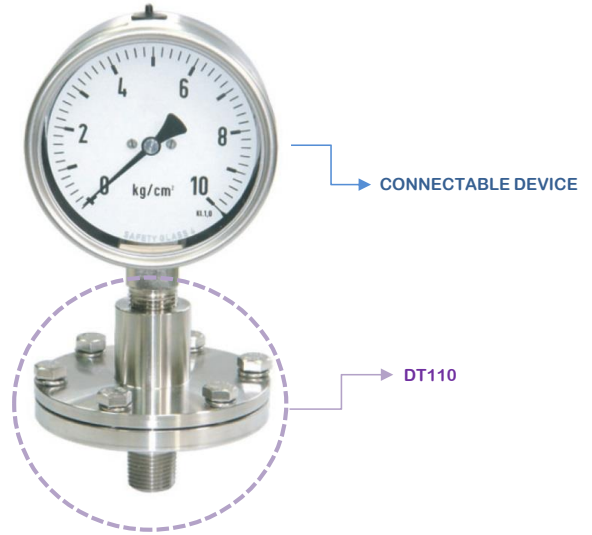

| FLOW | | PRESSURE | | TEMPERATURE | | AC | | DC | | BATTERY | | OUTPUT | | CONTACT | | DISPLAY |

SIZE & PRESSURE RANGE

Membrane Size	55Φ	75Φ
Minimum [bar]	0 ~ 6	-1~0, 0 ~ 4
Maximum [bar]	0 ~ 40	

DIMENSION (mm)

Item	Description of parts
a	Upper housing
b	Lower housing
c	Membrane
d	Instrument connection
e	Filling port
f	Process connection
g	Screw bolt

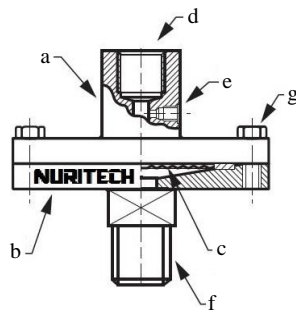



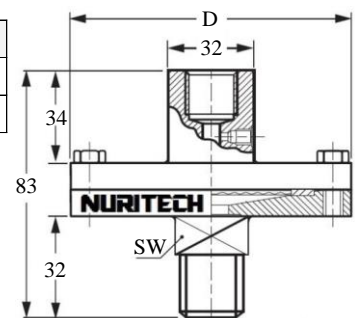



	Membrane Size		
Φ	55	75	95
D	80	100	120



제품의 사양에 따라 변경 될 수 있습니다.

CONNECTABLE DEVICES

						
Model	PG	PGS	DPG3500	DPG3000	PT3100	PT5000
Accuracy	±1.6% F.S.	±1.0% F.S.	±1.0% F.S.	±0.5% F.S.	±0.5% F.S.	±0.2% F.S.
Gauge outdia.	60mm	100mm	80mm	75mm		
Output					DC4-20mA	DC4-20mA
Range Unit : bar or kg/cm2	-1 ~ 0 0 ~ 4 0 ~ 6 0 ~ 10 0 ~ 16 0 ~ 25 0 ~ 40	-1 ~ 0 0 ~ 4 0 ~ 7 0 ~ 10 0 ~ 16 0 ~ 20 0 ~ 25 0 ~ 28 0 ~ 35 0 ~ 40	0 ~ 7 0 ~ 14 0 ~ 20 0 ~ 35	-1 ~ 0 0 ~ 7 0 ~ 35	-1 ~ 0 0 ~ 4 0 ~ 6 0 ~ 10 0 ~ 16 0 ~ 25 0 ~ 40	-1 ~ 0 0 ~ 4 0 ~ 6 0 ~ 10 0 ~ 16 0 ~ 25 0 ~ 40

| FLOW |
 | PRESSURE |
 | TEMPERATURE |
 | AC |
 | DC |
 | BATTERY |
 | OUTPUT |
 | CONTACT |
 | DISPLAY |



Ordering Information

DT110	Model			
	Code	Instrument Connection(Female)	Code	Instrument Connection(Female)
	A	1/4" BSP	D	3/8" NPT
	B	1/4" NPT	E	1/2" BSP
	C	3/8" BSP	F	1/2" NPT
	Code	Membrane size		
	B	ø55		
	C	ø75		
	D	ø95		
	Code	Process Connection	Code	Process Connection
	1	1/4" BSP	5	1/2" BSP
	2	1/4" NPT	6	1/2" NPT
	3	3/8" BSP	7	Option
	4	3/8" NPT		
	Code	Thread		
	M	Male		
	F	Female		
	Code	Upper housing material		
	S	SS316 [std.]		
	O	Option		
	Code	Lower housing material		
	S	SS316 [std.]		
	O	Option		
	Code	Membrane material		
	1	SS316L		
	2	Hastelloy C276		
	3	Tantalum		
	4	Option		
	Code	Connectable Devices		
	P	PG (fill range)		
	PS	PGS (fill range)		
	D35	DPG3500 (fill range)		
	D30	DPG3000 (fill range)		
	P3	PT3100 (fill range)		
	P5	PT5000 (fill range)		
	Code	Test Certi.		
	Y	Issue.		
	N	None.		

| FLOW | | PRESSURE | | TEMPERATURE | | AC | | DC | | BATTERY | | OUTPUT | | CONTACT | | DISPLAY |